

Resorts by Thai Architects





JW Marriott Phuket Resort and Spa

By Plan Associates;

Boonrit Kordilokrat, Praditchaya Singharaj



Location:	231 Moo 3, Mai Khao Beach, Talang Phuket, Thailand
Completion:	2002
Owner:	Royal Garden Development
Interior:	Abacus Studio
Landscape Architect:	Bensley Design Studio
Structural & System Engineer:	49 Engineering Consultants





There are 4 main design concepts unfolding here:

The first concept focuses on "Environmental Preservation". The project is located on Mai Khao Beach, adjacent to the Sirinath Marine National Park. This coastal area is very important as a sea turtle nesting area and, in recent times, the numbers of sea turtles have been growing less day by day. Hence, there are natural ponds to be preserved in the project's location. The designer joining the team specialized in Marine Science from Chulalongkorn University and has thoroughly studied the environment to come up with many design conclusions, which includes the main building to be located far away from the beach to reduce human intervention as much as possible. The rooms and common areas do not face the beach directly in order to avoid artificial lights intervening by shining toward the sea. Moreover there are a lot of activities that require cooperation from the owner (such as limiting activities) when the project is in use.

The second point is to design a building to "Reflect Vernacular Architecture". The combination of the building in Sino-Portuguese style with a Hip roof reflects vernacular architecture in the southern part of Thailand. The colonnade is designed to complement the climate that includes heavy rain on Phuket Island.

Third is the "Blending" where selected material and color blend perfectly with the natural surrounding, for example, the grey color and pattern of the roof intentionally reflect the color of the shell of a sea turtle, as well as using the natural color of wood and sand-wash. Moreover, the designer avoids expensive woods such as teakwood, but uses wood that is durable and available such as iron instead.

Fourth is the "Harmony of Building and Location". The concept of complementing with the natural setting can be seen from the material used and color of the building, which also relates to the alterations of the surrounding atmosphere in various time periods. The buildings are designed to promote and reflect the uniqueness of different times of the day, such as a glorious view of the sunset that can be seen in the reflecting pool.



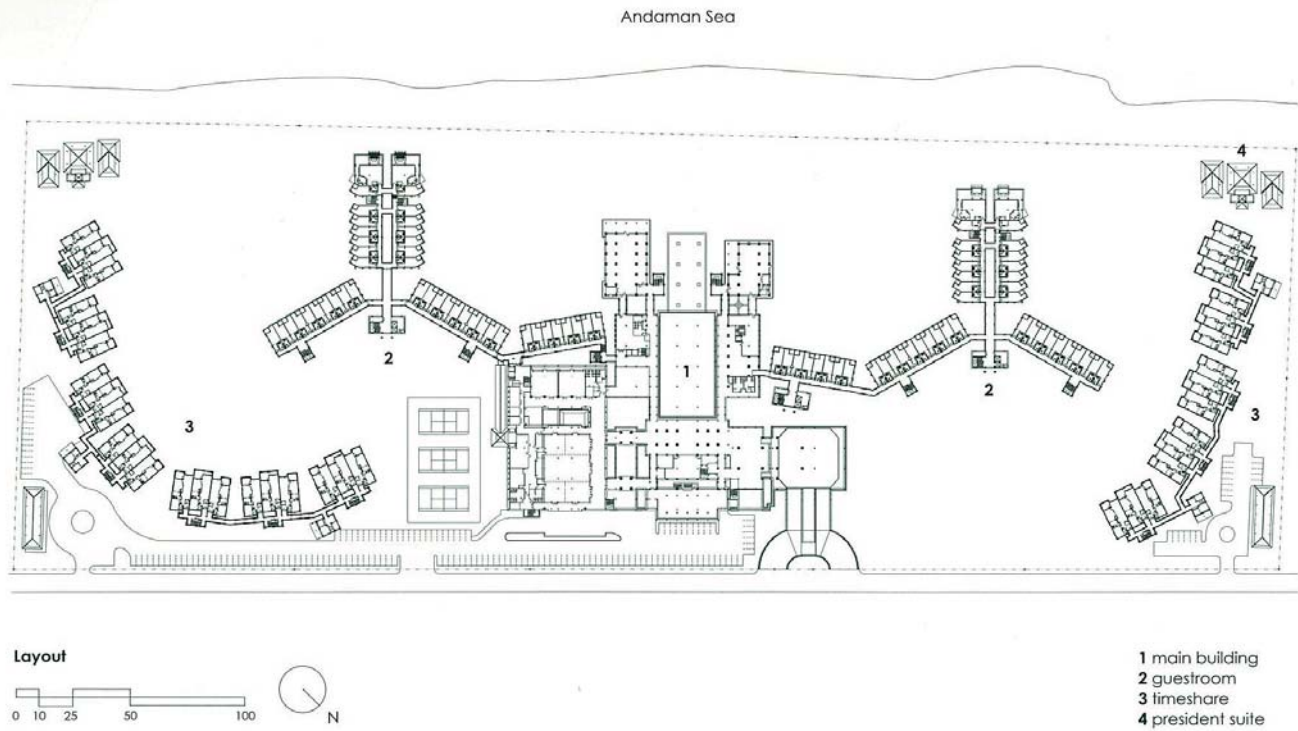

Elevation



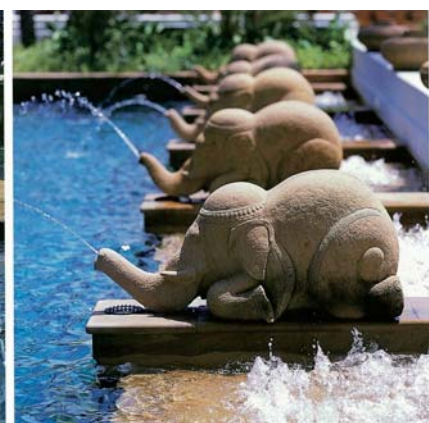
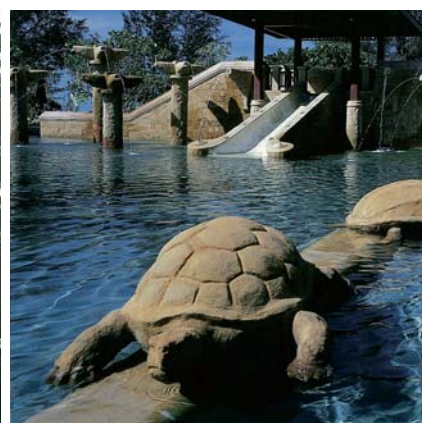

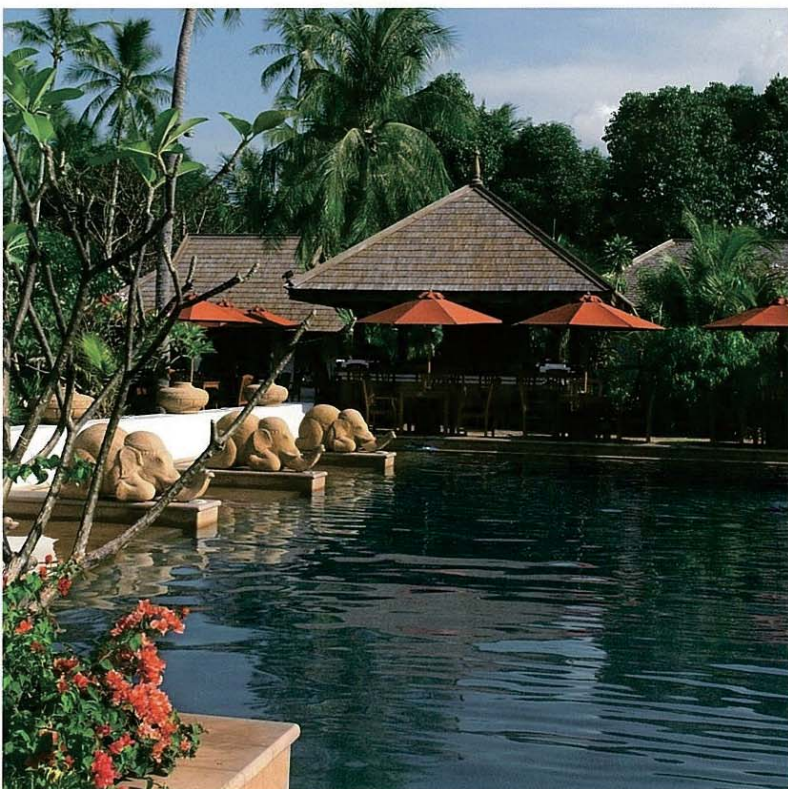







The open-air lobby and corridor is set around the reflecting pool.



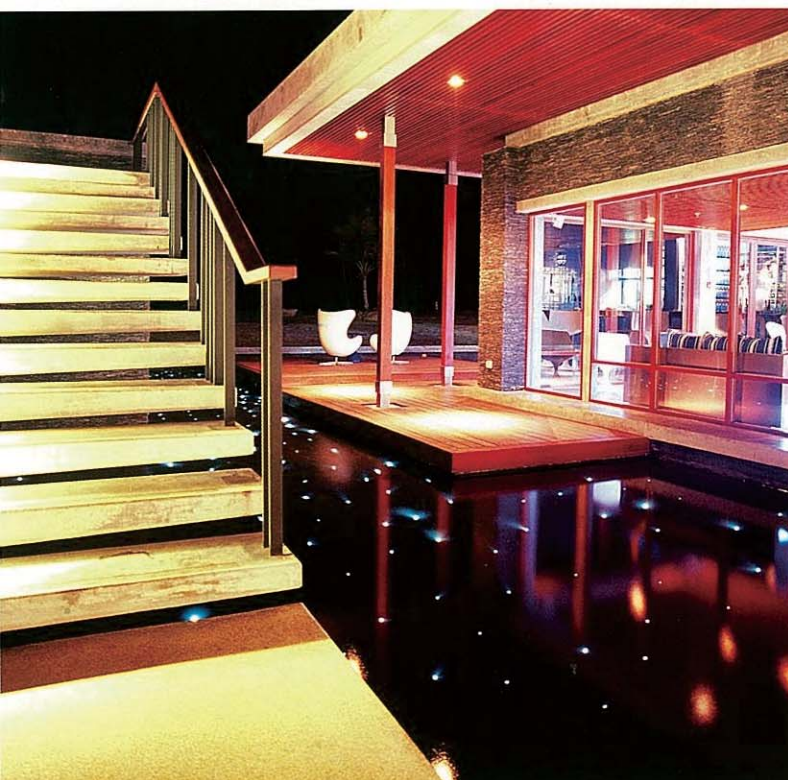
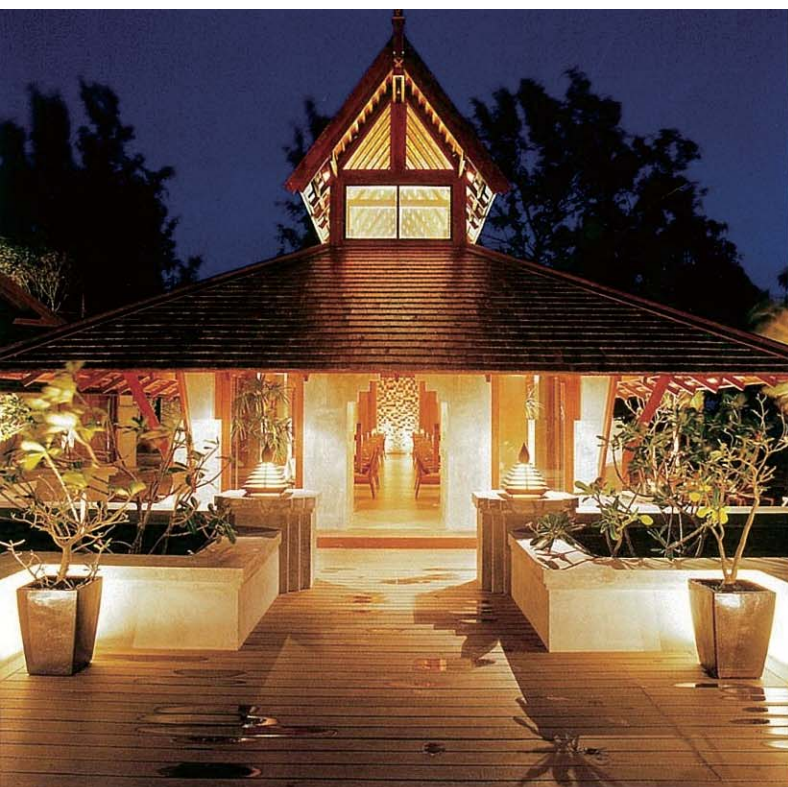





The simple architecture creates intense connections to nature.



The presidential suite with living pavilion and swimming pool.

